

222 Winkel 90°

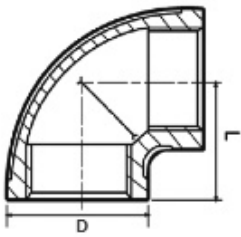

DIN EN 10241
ISO 228-1G

Wst. 316

Abnahmeprüfzeugnis
gem. EN 10204-3.1



inch	DN mm	L mm	AD mm	Ausf.	Artikel-Nr.
1/8"	6	19,0	17	guss	222
1/4"	8	21,0	21	guss	222
3/8"	10	21,3	24	guss	222
1/2"	15	27,0	29	guss	222
3/4"	20	33,0	36	guss	222
1"	25	38,0	43	guss	222
1.1/4"	32	45,0	52	guss	222
1.1/2"	40	50,0	59	guss	222
2"	50	57,0	72	guss	222
2.1/2"	65	69,7	87	guss	222
3"	80	77,0	100	guss	222
4"	100	98	126	guss	222

223 Winkel 45°

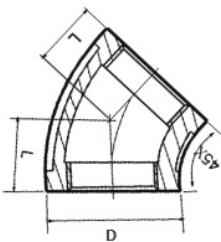

DIN EN 10241
ISO 228-1G

Wst. 316

Abnahmeprüfzeugnis
gem. EN 10204-3.1



inch	DN mm	L mm	D mm	Ausf.	Artikel-Nr.
1/8"	6	18,0	18,0	guss	223
1/4"	8	19,4	21,0	guss	223
3/8"	10	20,0	25,0	guss	223
1/2"	15	22,0	29,5	guss	223
3/4"	20	25,0	35,6	guss	223
1"	25	28,0	43,0	guss	223
1.1/4"	32	33,0	52,4	guss	223
1.1/2"	40	36,0	58,0	guss	223
2"	50	43,0	72,0	guss	223
2.1/2"	65	50,0	87,0	guss	223
3"	80	55,0	100,0	guss	223
4"	100	64,0	125,5	guss	223