

## 228 Kreuz-Stück

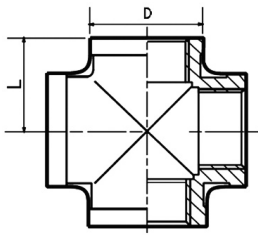

DIN EN 10241  
ISO 228-1G

Wst. 316

Abnahmeprüfzeugnis  
gem. EN 10204-3.1



inch	DN mm	L mm	D mm	Ausf.	Artikel-Nr.
1/8"	6	17,0	15,2	guss	228
1/4"	8	18,5	19,7	guss	228
3/8"	10	22,9	23,3	guss	228
1/2"	15	26,8	28,0	guss	228
3/4"	20	32,0	34,6	guss	228
1"	25	37,5	43,6	guss	228
1.1/4"	32	45,9	53,0	guss	228
1.1/2"	40	47,6	58,0	guss	228
2"	50	58,0	71,0	guss	228
2.1/2"	65	70,0	87,0	guss	228
3"	80	77,0	100,0	guss	228
4"	100	97	126,0	guss	228

## 227 Y-Stück

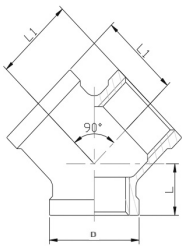

DIN EN 10241  
ISO 228-1G

Wst. 316

Abnahmeprüfzeugnis  
gem. EN 10204-3.1



inch	DN mm	L mm	L1 mm	D1	Ausf.	Artikel-Nr.
1/8"	6	10,0	17,0	17	guss	227
1/4"	8	13,0	19,0	21	guss	227
3/8"	10	14,0	23,0	25	guss	227
1/2"	15	18,0	27,0	29	guss	227
3/4"	20	20,0	32,0	35	guss	227
1"	25	23,0	38,0	43	guss	227
1.1/4"	32	28,0	46,0	52	guss	227
1.1/2"	40	30,0	48,0	58	guss	227
2"	50	34,0	57,0	71	guss	227