

Flansche

Vorschweißflansch
welding neck flange

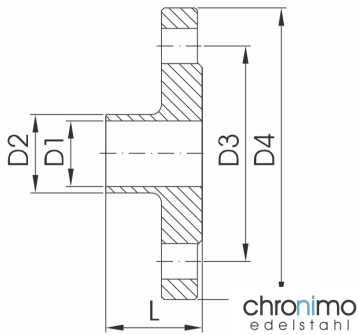

| DN | D1 | D2 | D3 | D4 | L | Gew.[kg] |
|-----|-----|-----|-----|-----|----|----------|
| 10 | 10 | 15 | 60 | 90 | 35 | 0,51 |
| 15 | 16 | 21 | 65 | 95 | 35 | 0,62 |
| 20 | 20 | 25 | 75 | 105 | 38 | 0,62 |
| 25 | 26 | 31 | 85 | 115 | 38 | 1,00 |
| 32 | 32 | 37 | 100 | 140 | 40 | 1,51 |
| 40 | 38 | 43 | 110 | 150 | 42 | 1,62 |
| 50 | 50 | 55 | 125 | 165 | 45 | 2,14 |
| 65 | 66 | 72 | 145 | 185 | 45 | 2,66 |
| 80 | 81 | 87 | 160 | 200 | 50 | 3,17 |
| 100 | 100 | 106 | 180 | 220 | 52 | 4,04 |
| 125 | 125 | 133 | 210 | 250 | 55 | 6,45 |
| 150 | 150 | 159 | 240 | 285 | 55 | 8,10 |

Vorschweißflansch mit Nut
welding neck flange with nut

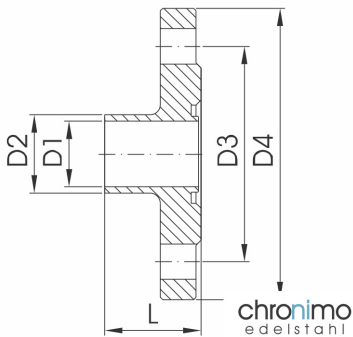

| DN | D1 | D2 | D3 | D4 | L | Gew.[kg] |
|-----|-----|-----|-----|-----|----|----------|
| 10 | 10 | 15 | 60 | 90 | 35 | 0,51 |
| 15 | 16 | 21 | 65 | 95 | 35 | 0,62 |
| 20 | 20 | 25 | 75 | 105 | 38 | 0,62 |
| 25 | 26 | 31 | 85 | 115 | 38 | 1,00 |
| 32 | 32 | 37 | 100 | 140 | 40 | 1,51 |
| 40 | 38 | 43 | 110 | 150 | 42 | 1,62 |
| 50 | 50 | 55 | 125 | 165 | 45 | 2,14 |
| 65 | 66 | 72 | 145 | 185 | 45 | 2,66 |
| 80 | 81 | 87 | 160 | 200 | 50 | 3,17 |
| 100 | 100 | 106 | 180 | 220 | 52 | 4,04 |
| 125 | 125 | 133 | 210 | 250 | 55 | 6,45 |
| 150 | 150 | 159 | 240 | 285 | 55 | 8,10 |

Glatter Flansch ND 10
flange plain ND 10

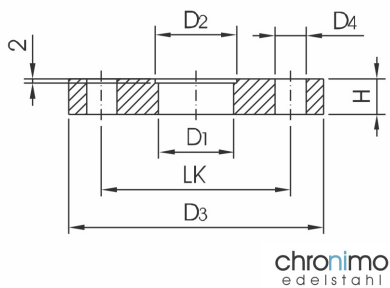

| DN | D1 | D2 | LK | D3 | D4 | H | Gew.[kg] |
|-----|-----|-------|-----|-----|------|----|----------|
| 10 | 10 | 12,2 | 60 | 90 | 14/4 | 14 | 0,50 |
| 10 | 10 | 13,2 | 60 | 90 | 14/4 | 14 | 0,50 |
| 15 | 16 | 18,2 | 65 | 95 | 14/4 | 14 | 0,60 |
| 15 | 16 | 19,2 | 65 | 95 | 14/4 | 14 | 0,60 |
| 20 | 20 | 22,2 | 75 | 105 | 14/4 | 14 | 0,85 |
| 20 | 20 | 23,2 | 75 | 105 | 14/4 | 14 | 0,85 |
| 25 | 26 | 28,2 | 85 | 115 | 14/4 | 14 | 1,11 |
| 25 | 26 | 29,2 | 85 | 115 | 14/4 | 14 | 1,11 |
| 32 | 32 | 34,2 | 100 | 140 | 18/4 | 14 | 1,64 |
| 32 | 32 | 35,2 | 100 | 140 | 18/4 | 14 | 1,64 |
| 40 | 38 | 40,2 | 110 | 150 | 18/4 | 14 | 1,80 |
| 40 | 38 | 41,2 | 110 | 150 | 18/4 | 14 | 1,80 |
| 50 | 50 | 52,2 | 125 | 165 | 18/4 | 14 | 2,30 |
| 50 | 50 | 53,2 | 125 | 165 | 18/4 | 14 | 2,30 |
| 65 | 66 | 70,5 | 145 | 185 | 18/4 | 14 | 2,88 |
| 80 | 81 | 85,5 | 160 | 200 | 18/8 | 16 | 3,20 |
| 100 | 100 | 104,5 | 180 | 220 | 18/8 | 16 | 4,00 |
| 125 | 125 | 129,5 | 210 | 250 | 18/8 | 20 | 5,00 |
| 150 | 150 | 154,5 | 240 | 285 | 22/8 | 20 | 6,70 |
| 200 | 200 | 205,0 | 295 | 340 | 22/8 | 24 | 9,00 |