

## Rohrschellen nach/ähnl. DIN 3567 ohne Schrauber.

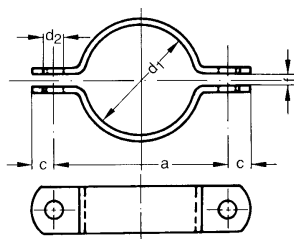

### Form A

ohne Mutter u. Schrauben

Maße nach DIN 3567

Maße ähnlich DIN 3567

Wst. 1.4571 / TP 316Ti

Wst. 1.4301 / 1.4307 / TP 304/304L

Abnahmeprüfzeugnis

gem. EN 10204-3.1 f.d.Vormaterial



DN mm	d1 mm	Zoll mm	a mm	c mm	d2 mm	f mm	Flach gem. DIN mm	Flach ähnl. DIN mm	6kt.Schrauben	GEWICHT Kg/Pair
15	20,0		57	15	11,50	7	30x5	30x3	M 10x30	0,19
15	22,0	1/2"	59	15	11,50	7	30x5	30x3	M 10x30	0,20
20	25,0		62	15	11,50	7	30x5	30x3	M 10x30	0,21
20	27,0	3/4"	66	15	11,50	7	30x5	30x3	M 10x30	0,22
25	30,0		68	15	11,50	7	30x5	30x3	M 10x30	0,23
25	34,0	1"	72	15	11,50	7	30x5	30x3	M 10x30	0,25
32	38,0		76	15	11,50	7	30x5	30x3	M 10x30	0,26
32	43,0	1 1/4"	82	15	11,50	7	30x5	30x3	M 10x30	0,28
40	45,0		84	15	11,50	7	30x5	30x3	M 10x30	0,28
40	49,0	1 1/2"	88	15	11,50	7	30x5	30x3	M 10x30	0,30
	54,0		98	18	14,00	9	40x6	40x4	M 12x35	0,55
50	57,0		104	18	14,00	9	40x6	40x4	M 12x35	0,56
50	61,0	2"	108	18	14,00	9	40x6	40x4	M 12x35	0,58
	70,0		114	18	14,00	9	40x6	40x4	M 12x35	0,64
65	77,0	2 1/2"	122	18	14,00	9	40x6	40x4	M 12x35	0,66
	84,0		130	18	14,00	9	40x6	40x4	M 12x35	0,68
80	89,0	3"	136	18	14,00	9	40x6	40x4	M 12x35	0,70
	104,0		162	24	18,00	11	50x8	50x5	M 16x45	1,55
100	108,0		172	24	18,00	11	50x8	50x5	M 16x45	1,59
100	115,0	4"	178	24	18,00	11	50x8	50x5	M 16x45	1,63
	129,0		188	24	18,00	11	50x8	50x5	M 16x45	1,75
125	133,0		196	24	18,00	11	50x8	50x5	M 16x45	1,78
125	140,0	5"	204	24	18,00	11	50x8	50x5	M 16x45	1,83
	154,0		214	24	18,00	11	50x8	50x5	M 16x45	1,96
150	159,0		222	24	18,00	11	50x8	50x5	M 16x45	2,00
150	169,0	6"	232	24	18,00	11	50x8	50x5	M 16x45	2,10
175	194,0		258	24	18,00	11	50x8	50x5	M 16x45	2,40
	204,0		202	24	18,00	11	50x8	50x5	M 16x45	2,45
200	216,0		280	24	18,00	11	50x8	50x5	M 16x45	2,55
200	220,0		284	24	18,00	11	50x8	50x5	M 16x45	2,64
250	254,0		336	30	23,00	14	60x8	60x5	M 20x50	3,75
250	267,0		342	30	23,00	14	60x8	60x5	M 20x50	3,85
250	273,0		348	30	23,00	14	60x8	60x5	M 20x50	3,90
	305		378	30	23,00	14	60x8	60x5	M 20x50	4,30
300	324,0		398	30	23,00	14,0	60x8	60x5	M 20x50	4,50
350	356,0		432	30	23,00	14,0	60x8	60x5	M 20x50	5,10
350	368,0		432	30	23,00	14,0	60x8	60x5	M 20x50	5,30
400	407,0		498	36	27,00	18,0	70x10	70x6	M 24x60	8,50
400	419,0		510	36	27,00	18,0	70x10	70x6	M 24x60	8,60
450	457,0		545	36	27,00	18,0	70x10	70x6	M 24x60	9,15
500	508,0		600	36	27,00	18,0	70x10	70x6	M 24x60	10,10
500	521,0		614	36	27,00	18,0	70x10	70x6	M 24x60	10,50
600	610,0		705	36	27,00	18,0	70x10	70x6	M 24x60	12,50
700	712,0		835	36	27,00	18,0	70x10	70x6	M 24x60	15,50
800	812,0		925	36	27,00	18,0	70x10	70x6	M 24x60	19,70